



S-Charge System

Battery System with Display
and Magnetic Charger

Steeper S-Charge System

The S-Charge System is a powerful internal battery system for myoelectric prostheses, with an OLED display and a magnetic charger, that is fitted into the prosthetic forearm. This allows the user to easily activate, deactivate and monitor the battery status on their prosthesis.



Included in the S-Charge System

S-Charge Hub

The S-Charge Hub is the central component of the S-Charge System with both the Display and the batteries connecting to it.

The Hub also contains the battery charge circuit, and similarly to the 3500S Battery Pack, the Hub can be configured to fit anywhere within the user's forearm for discreet and easy installation.

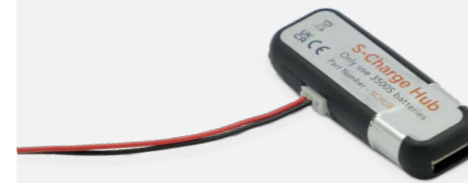

Display & Mounting Frame

With real-time battery life icons, the OLED Display provides increased feedback to the user, enabling them to monitor the remaining power on their prosthesis and be alerted when the charge drops below 10%. A symbol will also appear if there is a charging fault.

Sitting within a raised Mounting Frame, the Display is protected from accidental activation and being caught on clothes or accessories.



New 3500S Battery Pack

The 3500S Battery Pack has been specifically designed for the S-Charge System, and can be easily fitted within an adult forearm. The 3500S Battery Pack has an increased capacity of 3500mAh, providing the user with over four days of power dependant on usage.

Please note: The S-Charge System is only compatible with the 3500S Battery Pack.



Key System Features



High capacity battery system, capable of providing up to 4 days of power dependant on usage



The 3500S Battery Pack is easily housed within the forearm



With an increased capacity, the 3500S Battery Packs provides 3500mAh to the terminal device



Easy-release magnetic charger which fully charges the Battery Pack within 5 hours from empty



Flexible configuration as the hub can be placed anywhere in the forearm

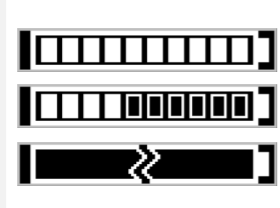

OLED display shows real-time battery life icons



Simple one-button operation to activate and deactivate the prosthesis



Automatic Sleep mode activation to save power

S-Charge System: Sample Setup

Short Wrist

(Order the Short Wrist Connector Cable separately, part no: CBBHA72. Electrodes not included)

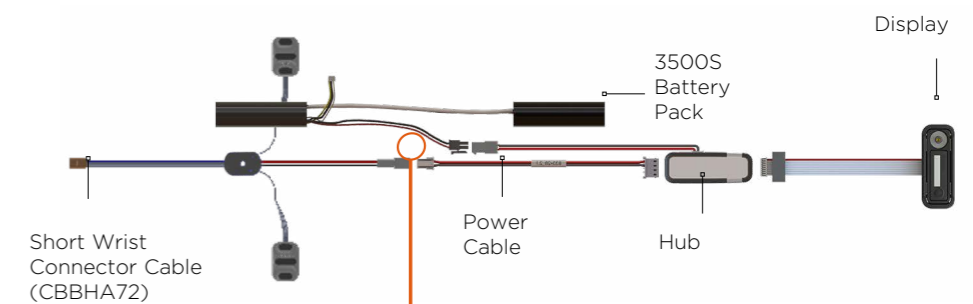

EQD Wrist

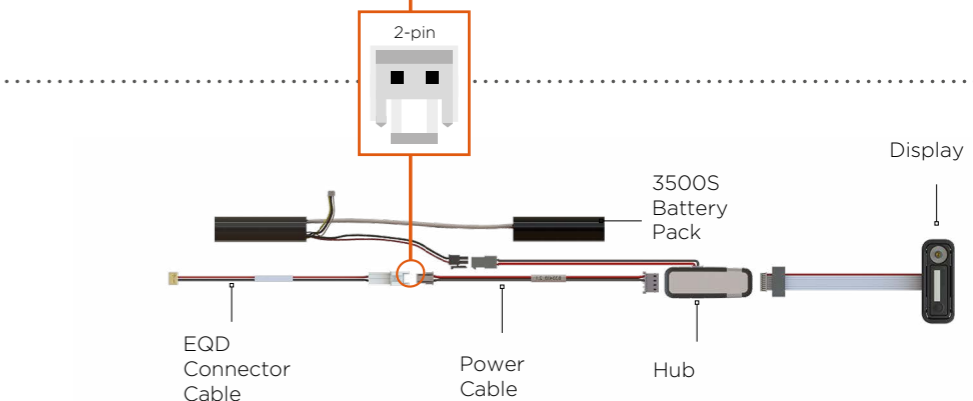

Technical Information

System Compatibility

The S-Charge System is compatible with other upper limb manufacturers systems with a power rating of 8.4V at full battery charge, 7.0V at low battery cut off, 2.5A peak current.

Please contact your local service centre for guidance.

Please note: The S-Charge System is only compatible with the Steeper 3500S Battery Pack.

3500S Battery Pack

Dimensions (not inc cables)	67 x 20 x 22mm
Total Weight	106g
Capacity	3500mAh
Voltage	Nominal 7.2 V
Current	2.5A peak current

S-Charge Hub

Length	58mm
Width	20mm
Thickness	10mm

Display & Mounting Frame

Size	50 x 20 x 7mm
------	---------------

S-Charge System Ordering Information

Complete S-Charge System SC3500

Includes:

- 3500S Battery Pack with lamination dummy
- Display
- Hub
- Magnetic wall charger with UK, US, EU, AUS mains adapters
- Power connector cable
- EQD connector cable
- 3 x Lamination dummies, mounting frames and foam gaskets
- 2 x Alignment stickers



Spare Parts

Part Number

3500S Battery Pack

SCBP3500

S-Charge Hub Kit

Hub, power connector cable, EQD connector cable

SCHUB

S-Charge Display Kit

Display, mounting frames (3), mounting frame gaskets (3) and alignment stickers (2)

SCDIS

S-Charge Wall Charger

Wall charger including mains adapters (UK, US, EU, AUS)

SWC2200

S-Charge Dummy Kit

3500S battery lamination dummy (1 pair), hub dummy, display dummy, alignment stickers (2)

SCDKIT

S-Charge Mounting Frame Kit

Mounting frames (3), mounting frame gaskets (3), alignment stickers (2)

SCMFKIT

S-Charge 3500S Battery Pack Lamination Kit

SCLAM

Extended EQD Connector Cable (500mm)

B33736

For more information on the S-Charge System or to place an order please contact customerservices@steepergroup.com or call +44 (0) 870 240 4133.